

Instruction Manual

SANDER WALL LXR850-CS



PLEASE READ THE MANUAL AND KEEP IT IN A PLACE WITH EASY ACCESS FOR REFERENCE BEFORE INSTALLING, ASSEMBLY AND OPERATING THE MACHINE. USE PERSONAL PROTECTIVE EQUIPMENT AND OBSERVE ALL SAFETY INFORMATION. OPERATE IN DISAGREEMENT WITH THIS MANUAL MAY CAUSE DAMAGE TO THE OPERATOR AND ALSO DAMAGE THE PRODUCT.



This machine is designed for sanding masonry walls, plaster and spackle. Please take all safety precautions when using this equipment. Please read this manual before operating the equipment.

2. TECHNICAL SPECIFICATIONS

Model	LXR850-CS
power	850W
Adjustment Speed	800-1.700 RPM
Sanding disc diameter	225mm
Tube diameter	32mm
Net weight	4,2 Kg

220 Volts / 60Hz

3. TECHNICAL INSTRUCTIONS

Attention! Read and follow all safety instructions.

3.1 Safety Tips Concerning the Work Area.

- a) Keep the workplace clean and tidy.
- b) Do not work near explosive material, atmosphere or liquids.

3.2 Electrical Safety Tips

- a) Do not modify the original cable length and never alter the machine's original plug.
- b) Avoid contact of body parts on electrical wires or suction tubes.
- c) Do not expose the sander to rain or humidity conditions.
- d) Never pull or transport the sander through the electrical power cord.
- e) Keep the electrical power cord away from sharp or moving objects.
- f) If damp site operation cannot be avoided, please secure the wiring in order to avoid the short.

3.3 Personal Safety Tips



- a) Always be alert.
- b) Never use the equipment when you are tired or under the influence of drugs, alcohol or medications strong.
- c) Use personal protective equipment such as gloves, masks and safety glasses.
- d) When operating, stay upright and on a safe and balanced basis at all times.
- f) Do not wear loose clothing and always keep your hair up.

3.4 Main cares

- a) Do not force the sander too hard against the wall.
- b) Always unplug the sander before making any repairs or removing or fitting any accessories.
- c) Always keep the product out of the reach of children or persons not trained for the same.
- d) Preserve your sander. Before operating, make sure that all parts are securely fastened to the equipment.
- e) Keep the equipment clean at all times.
- f) Always use the sander in accordance with the instructions.

3.5 Services and Assistance

- a) The warranty of this equipment is of 06 (six) months, which refers to the 03 (three) months of legal warranty) + 03 (three months of extended warranty from the supplier). During this period any maintenance must be performed in assistance technique registered by Nauber, which can be located in WWW.NAUBER.COM.BR.
- b) Always use original factory parts

4. PRECAUTIONS ABOUT THE CORRECT USE OF THE PRODUCT

Attention! Take all basic measures in order to avoid electrical shocks, injuries and burns before using the product. These instructions should be kept in a safe and easily accessible place.

- a) The equipment must not be used in environments where there is an explosive atmosphere.
- b) Do not use the electrical cord wrapped around your body.

- c) Do not use the machine in work inappropriate to its characteristics. For example; Sanding stones, barbs of wood, etc.
- d) In case of repair, use only original parts, otherwise you may lose your product warranty.
- e) When replacing rotating accessories, please couple products compatible with the characteristics of the originals so that there are no breaks or cracks in the parts causing damage to the machine and the operator.
- f) Never use the machine without first checking the rotating accessories, if there is any crack, cracks or anything suspicious, please do not use the equipment. Take it to the trained professional for repair.
- g) Never remove the sander from the wall before it has come to a complete stop, otherwise you may lose it control of the machine causing an accident and also disproportionately marking or sanding the surface desired.
- h) Clean the suction parts of the sander regularly, preferably whenever there are intervals of job.
- i) For a better use of the NAUBER sander, always choose the right sanding disc with the surface and the result.
- j) NAUBER always recommends the use of gloves and safety glasses.

5. HOW TO USE THE NAUBER MOD. LXR850-CS

Attention! Before preparing the machine, repairing, or performing any maintenance, make sure that the on/off button is in the Tur OFF position and also that the plug is unplugged from the outlet.

This equipment has an autonomous suction system through the turbine positioned in the upper part of the engine of the equipment. It is essential that after use, the suction holes are cleaned positioned on the sanding base, as well as cleaning the collector bag every 1 (one) hour of work.

5.1 Before starting the operation, please check:

- a) Check that the voltage of the electrical network matches the information on the equipment label.
- b) Before using the equipment, carefully read the Machine Manual.

5.2 How to operate the Nauber LXR850-CS sander:

- a) Release the lock key and take the extension rod to connect with the machine.

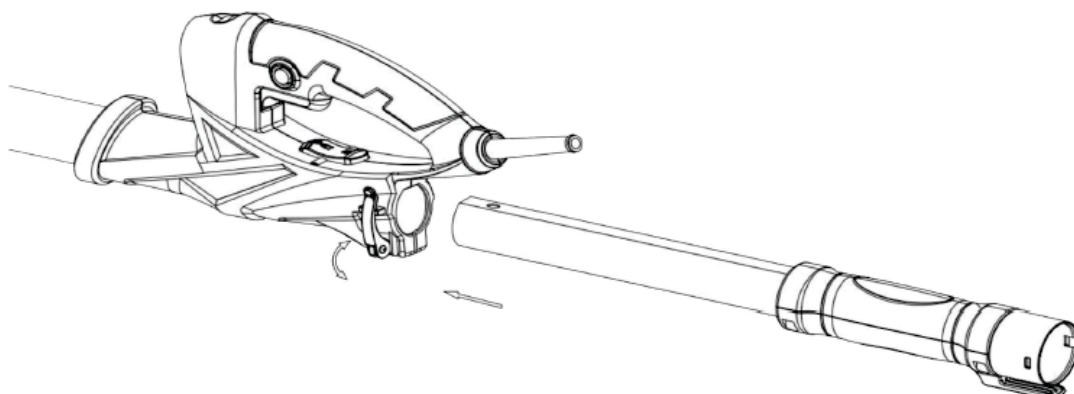

b) Take the pickup bag and connect it to the underside of the sander handle, as shown in the figure below:

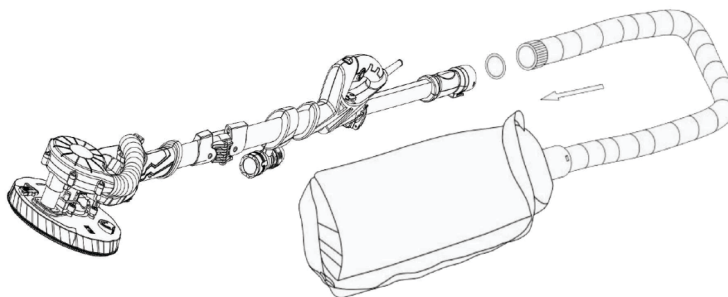

5.3 Electrical control

See below for ways to turn on, turn off and control the speed of your NAUBER LXR850- CS sander.

a) lock speed button.

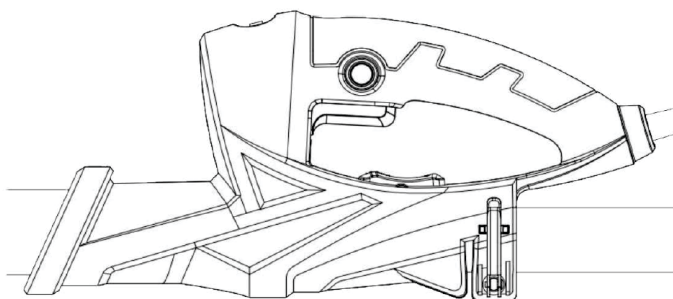

b) Speed adjustment knob.

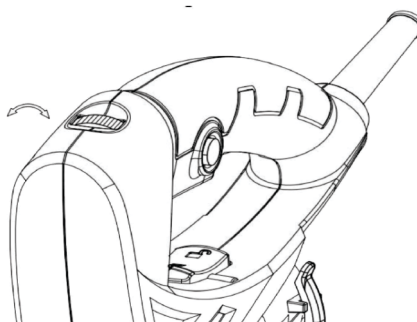

5.4 How to replace the sandpaper base plate

a) Insert the Allen key size five (5) into the central screw of the plate.

b) Hold the plate firmly and turn the Allen key until the screw is released.

c) After removing the old dish, place the new one and do the same procedure.

d) The same procedure for preventive cleaning is recommended.

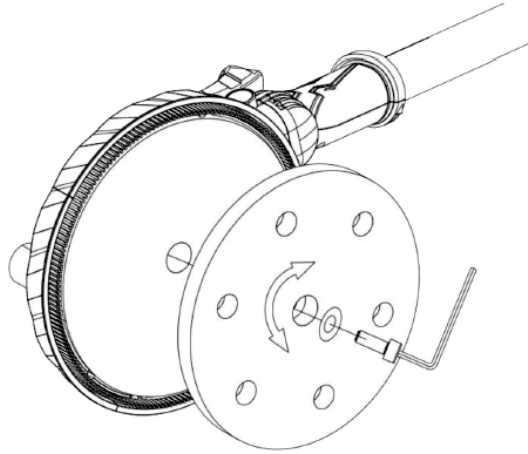

Attention! Only use original Nauber parts!

5.5 How to attach the sandpaper

a) Always use sanding discs with Velcro and holes.

b) Place the sanding disc on the plate according to the holes for better absorption.

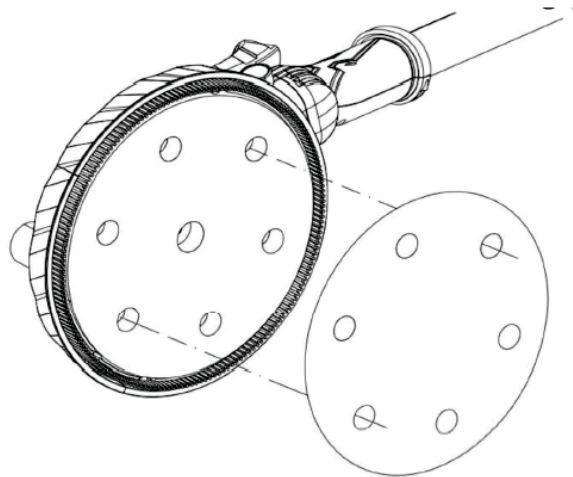

5.6 LED light

LED light with 3.8W and directional adjustment to facilitate work in dark or little places luminosity.

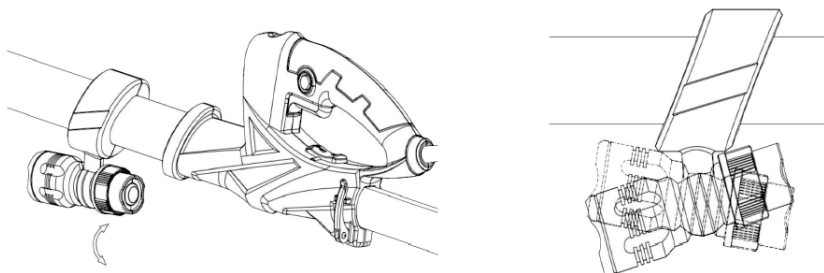

5.7 How to adjust the suction capacity

- a) Clockwise direction reduces suction capacity.
- b) Counterclockwise direction increases suction power.

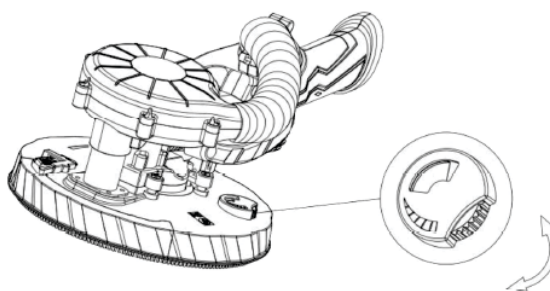

5.8 How to sand the edges or corners of the wall

- a) Part of the brush can be removed, facilitating the sanding of corners that are difficult to access.

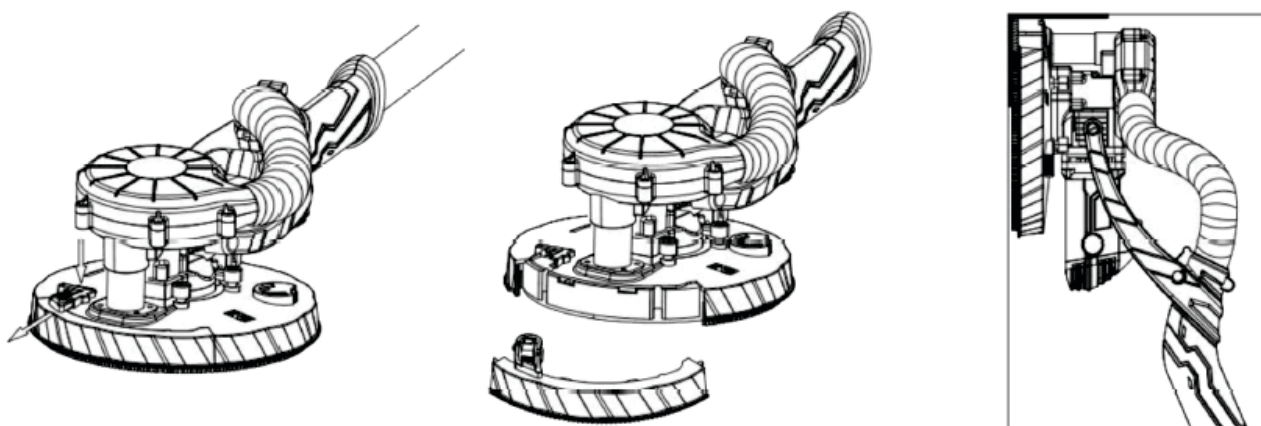

Attention! Be careful when bringing the sander close to corners or boxes of light without the protection, as it can cause damage to the foam base.

5.9 How to change the hose of the collector bag

a) Loosen the fastening ring with the screwdriver and remove the hose from the catch bag.

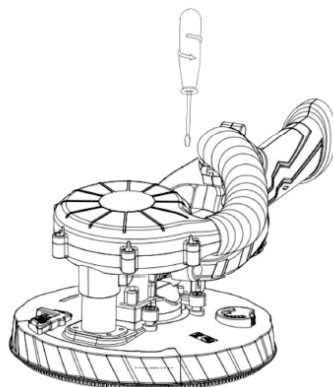

b) Rotate the hose counterclockwise and pull.

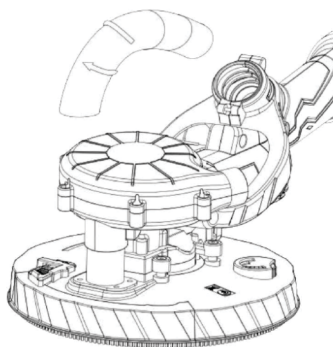

5.10 How to decouple the extension rod

a) When you uncouple the extension, pull the side lever to the limit and then pull the extension.

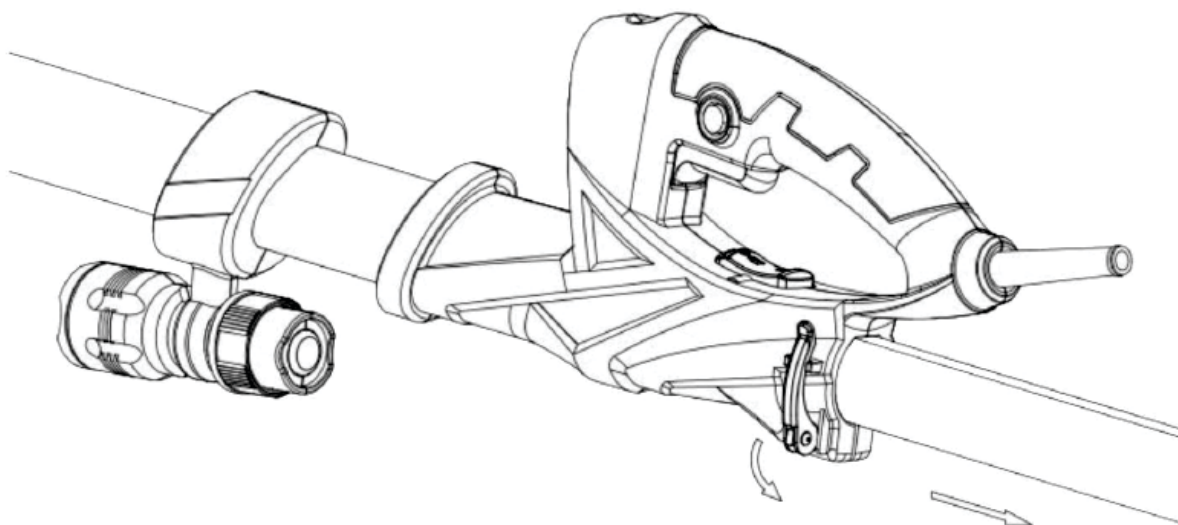

6. WORK TIPS

- a) Always use both hands to control and hold the sander.
- b) Before operating the machine, make sure that all parts are attached to the equipment.
- c) Connect the sander to the electrical network only on 220v.
- d) Before turning on the sander, touch it to the surface you want to work on and then turn on the machine. This prevents you from marking the wall due to the first contact. Turn off the machine with the sander leaning against the surface, after turning off the rotation, remove it.
- e) For high walls, make short movements.
- f) For ceilings make long movements.
- g) For the best effect, avoid pressing the machine and rubbing the sandpaper.
- h) After use, clean the machine properly.

7. HOW TO CARE AND REPAIR THE SANDER NAUBER MOD. LX850-CS

7.1 Initial Remarks

- a) To repair or replace parts of the equipment, always remove the plug from the socket.
- b) Always keep your equipment in a dry and safe place.
- c) If the power cord is damaged, replace it immediately.
- d) If the repair requires a more refined technical qualification, please forward the product to assistance authorized technique.

7.2 Cleaning

- a) Keep the safety, ventilation and engine as free as possible from dirt and dust.
- b) Clean the equipment with a damp cloth and neutral soap. Do not use solvents.
- c) Do not wash with running water or with a jet of water. Never submerge the equipment.

7.3 Charcoal Brushes

- a) One of the most common symptoms of charcoal brush wear is loss of power from the equipment.

8. COMMON SYMPTOMS AND SOLUTIONS

8.1 The sander is connected to the network but does not work

- a) Check if the cable wires are loose from the machine or if it is not properly fitted into the socket.
- b) Check that there is no break in the power cord.

8.2 When you turn on the sander, you hear strange noises in the engine

- a) Check that the engine is not stopped or slow due to accumulation of dirt.
- b) Check that there is no part blocking the engine.
- c) Too much pressure during the task.





8.3 Engine heats up

- a) Check if any element is not obstructing the ventilation.
- b) Check that the bearing is not damaged.
- c) Check that the operator is not putting too much pressure on the equipment when performing the sanding.

8.4 High and frequent sparks in the switch

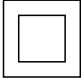
- a) Check that there is no short circuit in the motor armature.
- b) Damaged charcoal brushes.
- c) Dirty switch.

8. SYMBOLS AND MEANINGS ON THE LABEL OF YOUR SANDER

v	Volts	Hz	Hertz
~	alternating current	W	Watts
n ₀	speed start	/min or min ⁻¹	Speed per minute
	device with class 2 insulation		Please read the manual
	Use of noise muffler		Use security glasses



Before use the equipment read the manual with attention



Always use noise muffler when use this equipment



Always use security glasses for this equipment



Always use security mask for this equipment

WARRANTY TERM

Equipment: SANDER LXR850-CS

Delivery Technical: No () Yes () Date ____/____/____

1) Warranty Conditions:

1.1 Upon receiving the equipment, it is necessary that the buyer verify its conditions, and its set of parts, with any complaint due to lack of objects or other malfunctions only will be accepted if observed at the time of delivery, before the signature of the note stub purchase tax. It must be communicated immediately to the supplier.

1.2 The warranty period for this equipment is 03 (three) months by force of law (legal warranty)+ 03 (three) months of extended warranty, totaling 06 (six) months of warranty, counted from the date of issuance of the invoice.

1.3 By this warranty, the supplier undertakes to repair or replace parts that have manufacturing defects or defects, provided that they are in accordance with the clauses established in this term.

1.4 During the warranty period, any maintenance that is required must be communicated to the supplier, and it may only be carried out with the authorization of the supplier. Such non-compliance will result in the loss of the warranty.

1.5 The warranty is granted on an exclusive basis for any maintenance or repairs are carried out at the supplier company's headquarters. The procedure to trigger the guarantee is will give by sending the email request to the electronic address atendimento@nauber.com.br, informing the problem that occurred, with photos, and wait for them guidelines for sending the equipment by the carrier to the supplier's headquarters to carrying out the assistance.

1.6 Within the warranty period, the freight costs will be borne by the supplier.

1.7 The warranty of the replaced parts are grouped together with the total warranty, not characterizing this forms the extension of the period.

2) Results in loss of Warranty:

2.1 Defects arising from misuse, inadequate transport, loss of parts, lack of cleaning of equipment, or other evidence of factors caused by accident or force of nature, such as; flooding, fires, electrical burns, fall, theft, depredation, and alike. 2.2 If the equipment is used on the electrical network outside the specified standards.

2.3 If it is found that the equipment has been violated, or subjected to technical interventions, it has not authorized by the supplier, as well as replacement of parts, alteration of the electrical circuit or security devices.

2.4 Negligence or malpractice in the use or handling of the equipment by submitting it to applications several of the recommended ones, or the work under excessive force.

3) Items Not Covered by Warranty:

3.1 In the event of the need for technical assistance, the damages do not form part of the guarantee by the stoppage of work, lost profits, expenses with equipment operators, or materials that deteriorate due to the non-functioning of the equipment, as well as, there is no coverage of any personal or material damage to the buyer or to third parties.

3.2 Parts that have wear and tear, such as pistons, are not part of the warranty discs, sandpaper, and others that are related to time of use and natural wear.

3.3 Defects in painting and general functioning caused by external influences, weathering, poor conditioning of the equipment, or exposure to chemical products.

3.4 Noise and other factors that may arise due to abnormal conditions of use.

4) General Provisions:

4.1 If the warranty is triggered, and no defects or manufacturing defects are found, it will be borne of the buyer bearing the expenses of; labor, parts and supplies due to natural wear or misuse, travel expenses, and accommodation.

4.2 It is recommended to the buyer who does not have technical knowledge of using the equipment purchased, contract the technical delivery, which will be charged by the supplier of according to the complexity of each equipment, to be previously combined in separate negotiation.

4.3 No requests for technical assistance will be received outside the afore mentioned conditions in item 1.4, being an indispensable condition for the opening of the call.

4.4 This guarantee will be suspended if the purchase is in default with the supplier. Returning to be in force with the settlement of debts. The supplier reserves the right at any time to change its equipment and technologies or discontinue them, with no obligation to supply parts of models already sold, as well as, it will not characterize defective any equipment already sold with technology inferior to current sales model.